

**STEFAN KAHN**

Representative work: Technical Illustration

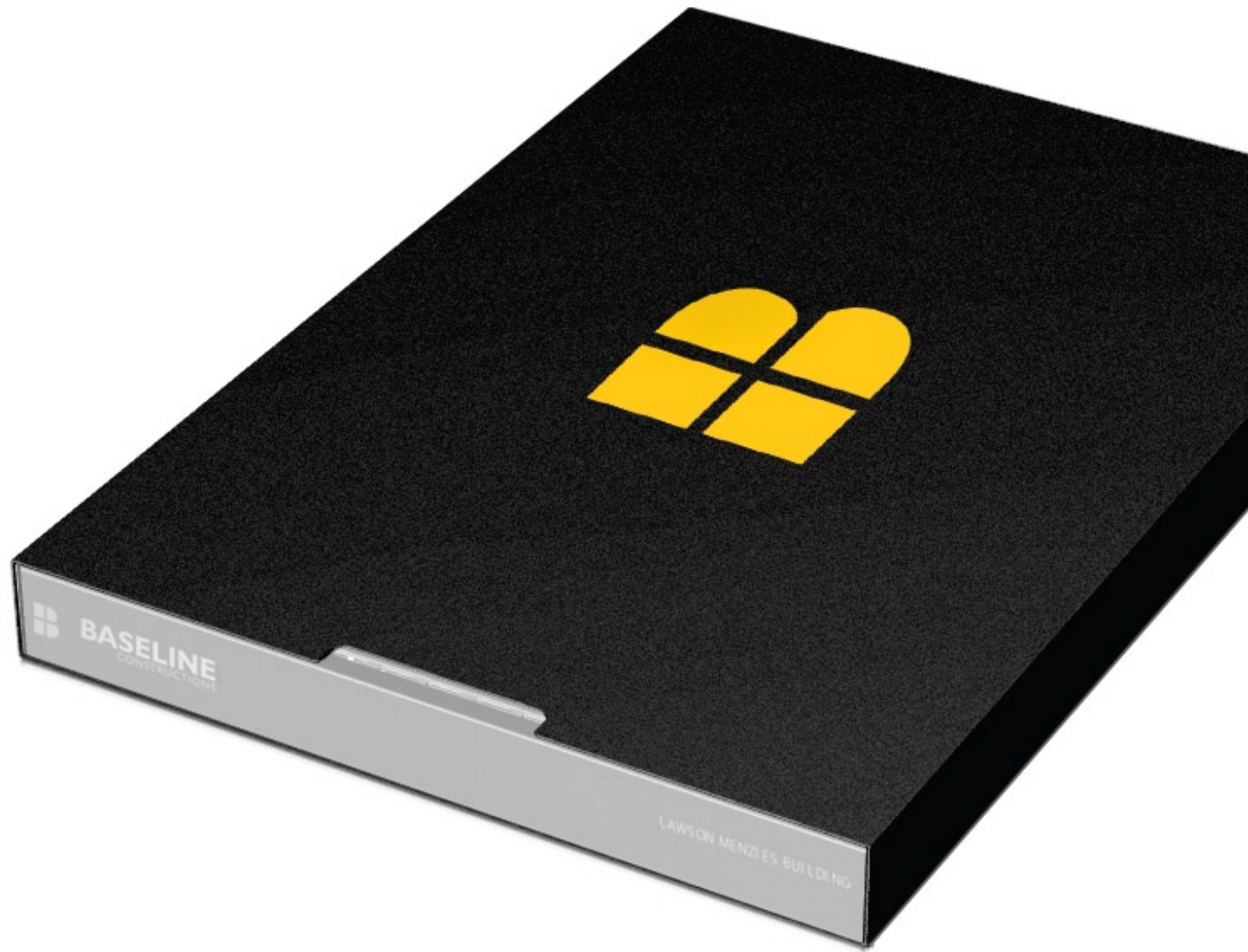

3D model & Photoshop render

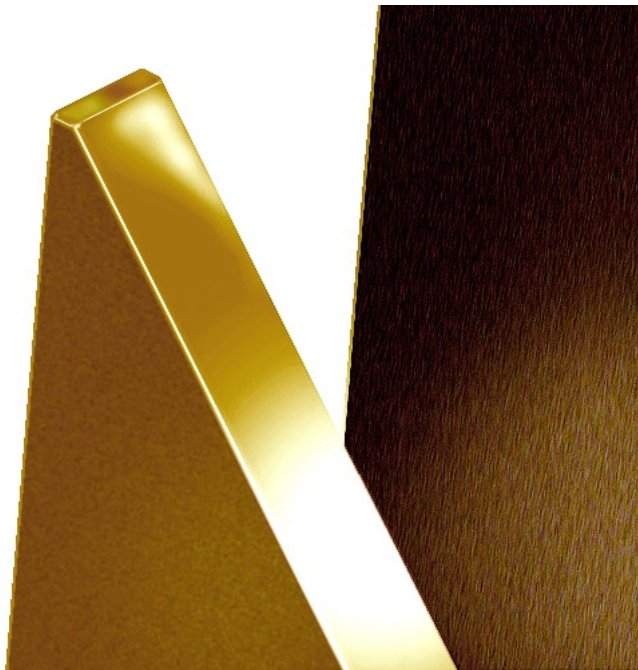
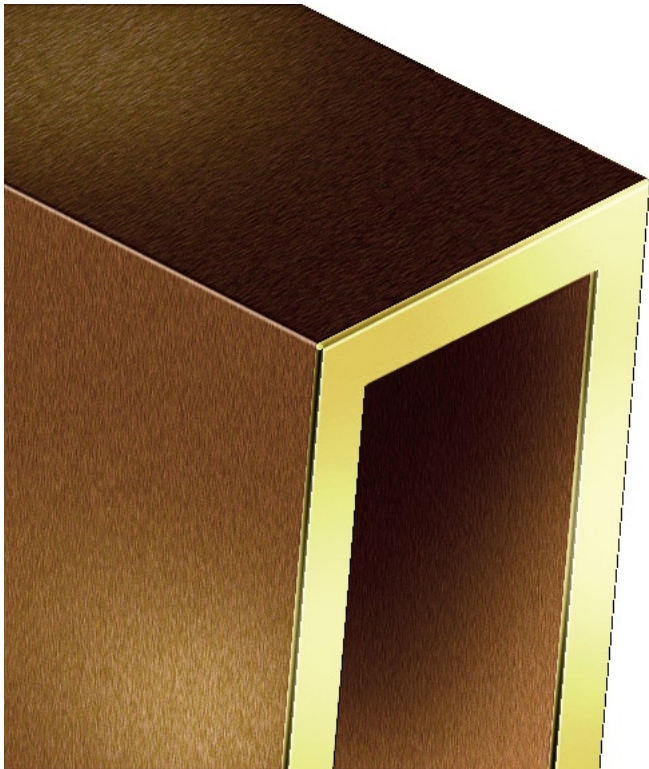
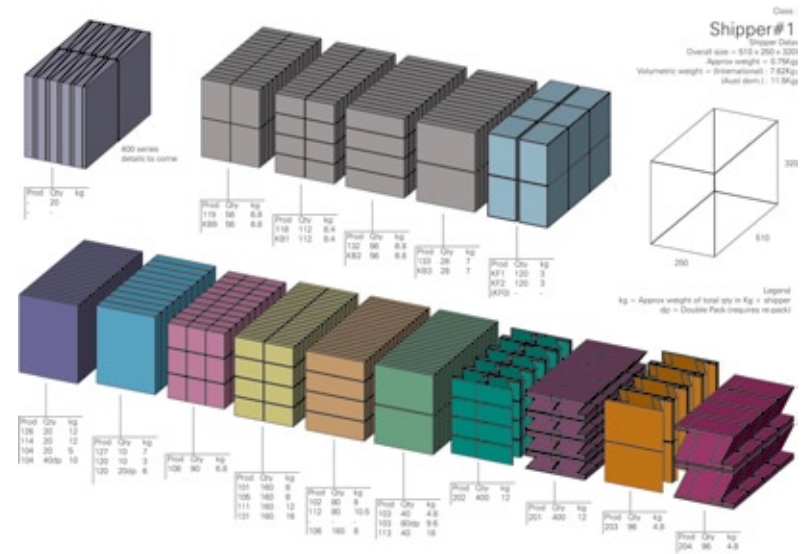
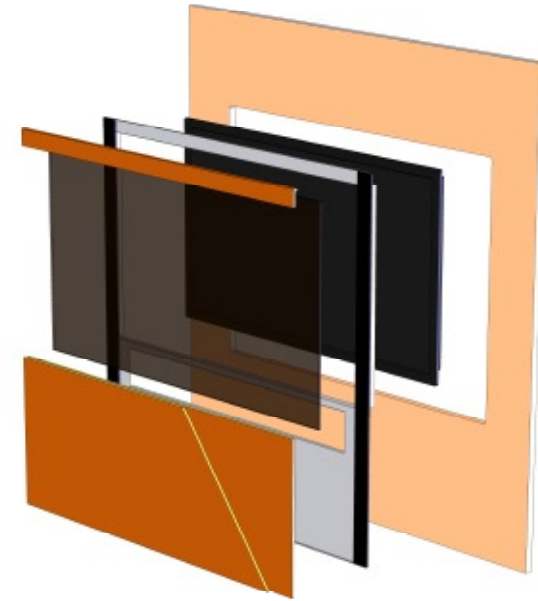
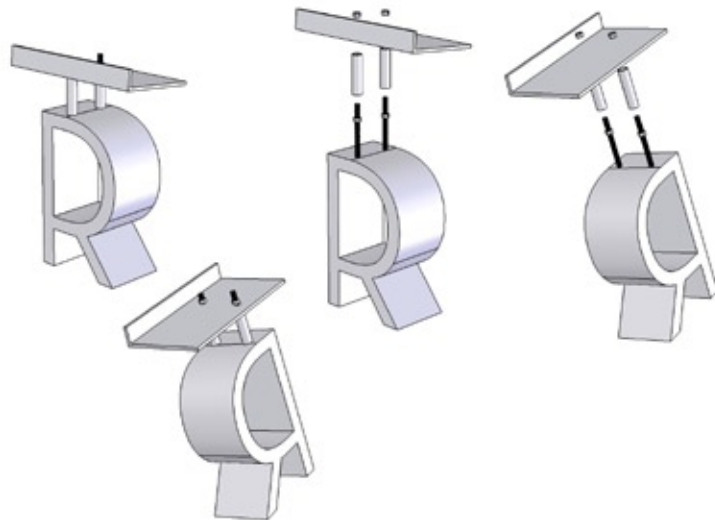
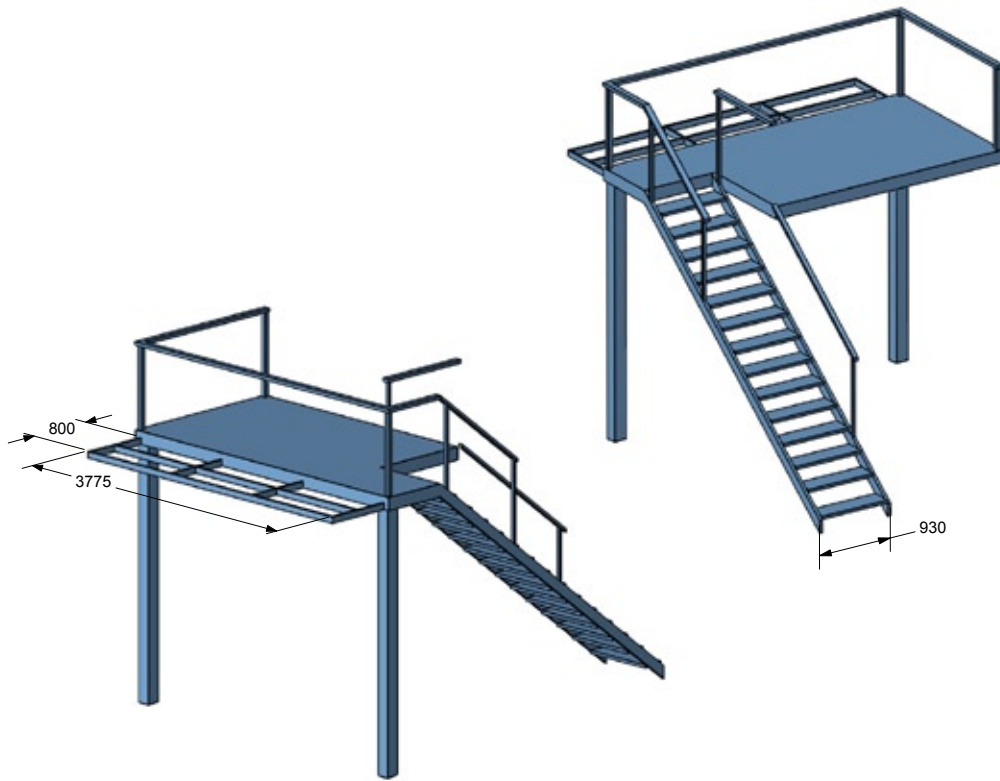

3D model, no rendering



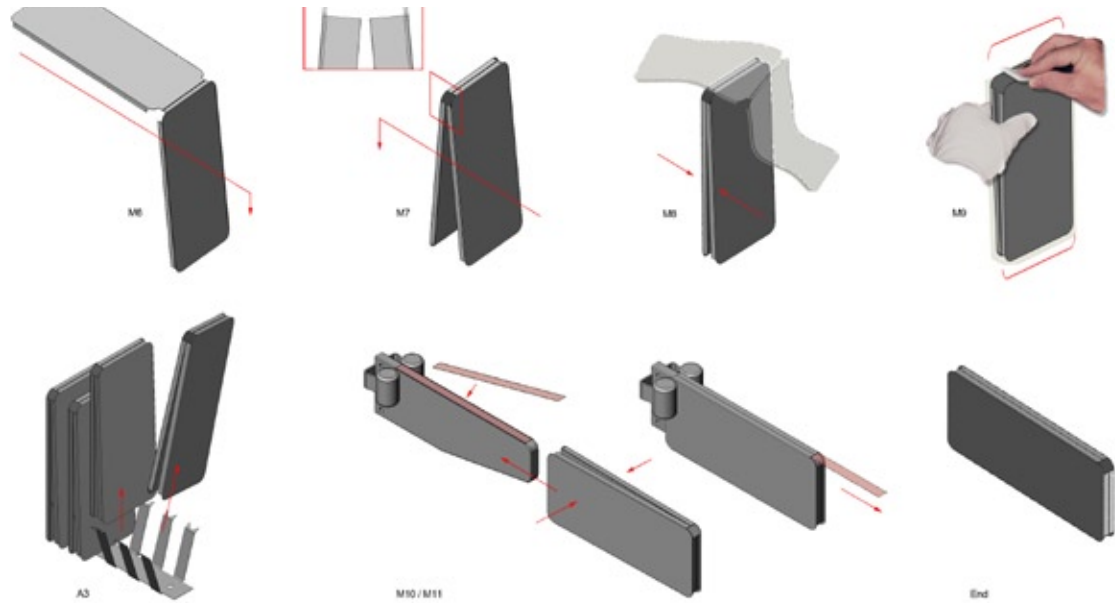
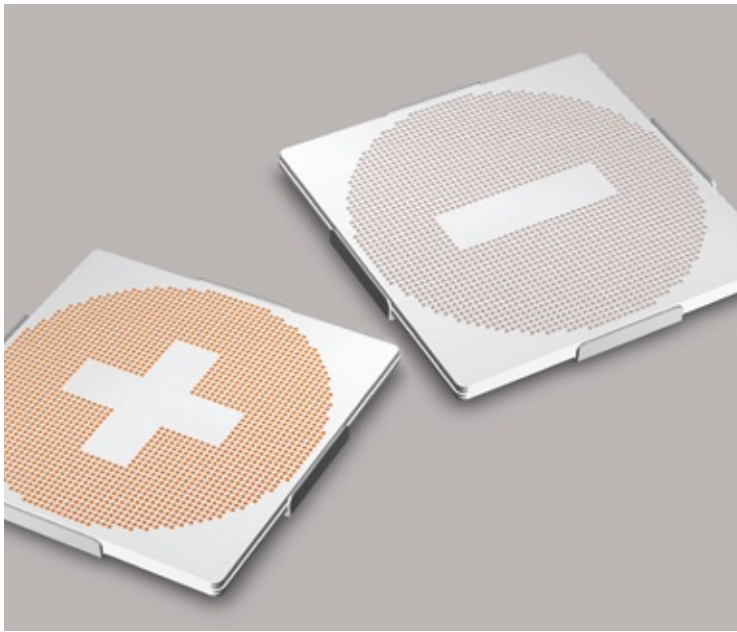

3D model, 2D render, photography

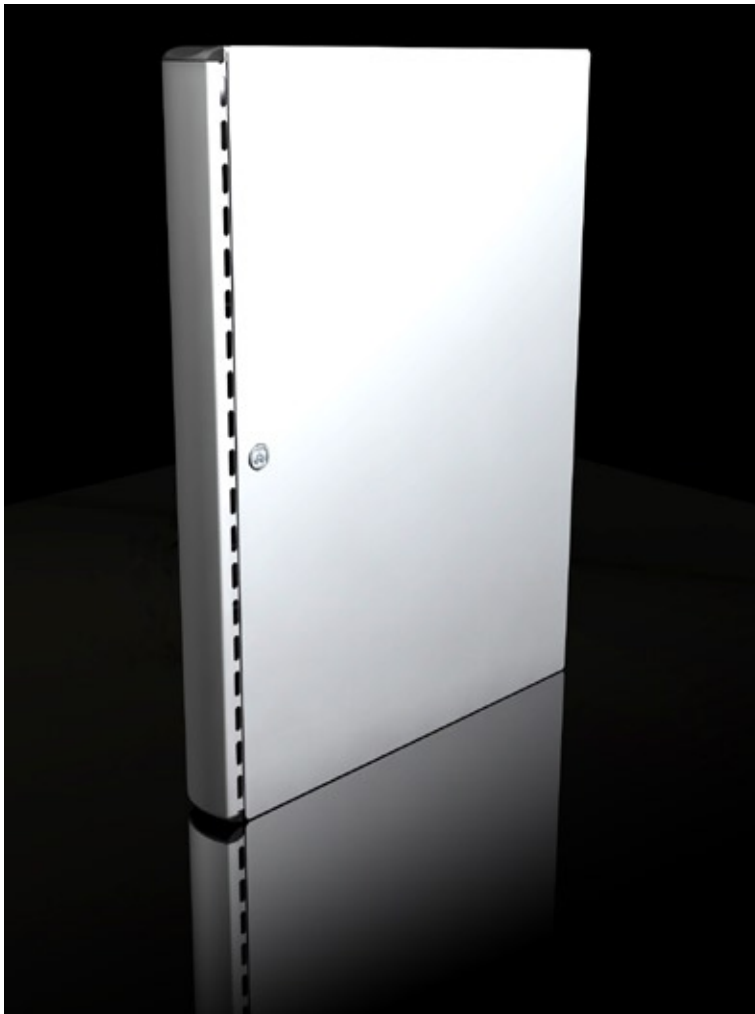

## OPTION 2

Summary:  
New design form  
Use existing metal logo tools (if possible)  
All-metal construction  
Swivel fob loop



Finishes:  
Black chrome body  
Bright chrome logo  
Bright chrome fob loop and split rings



3D model, 3D photographic render

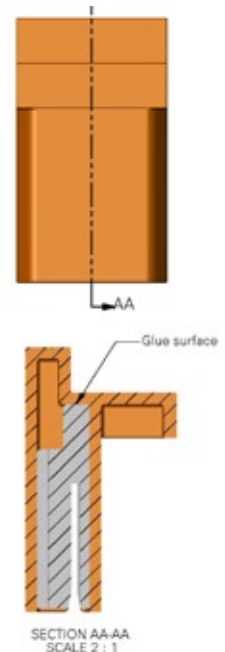
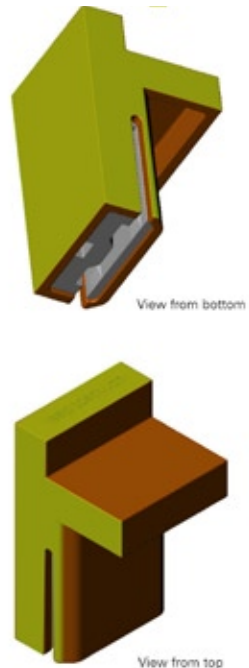
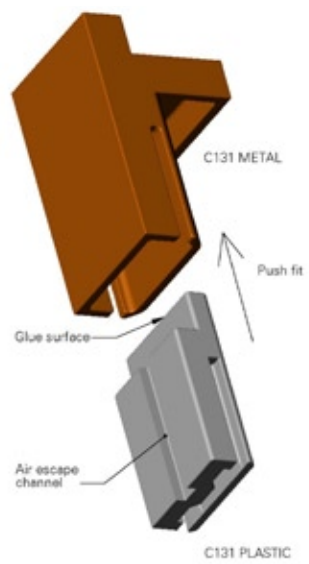
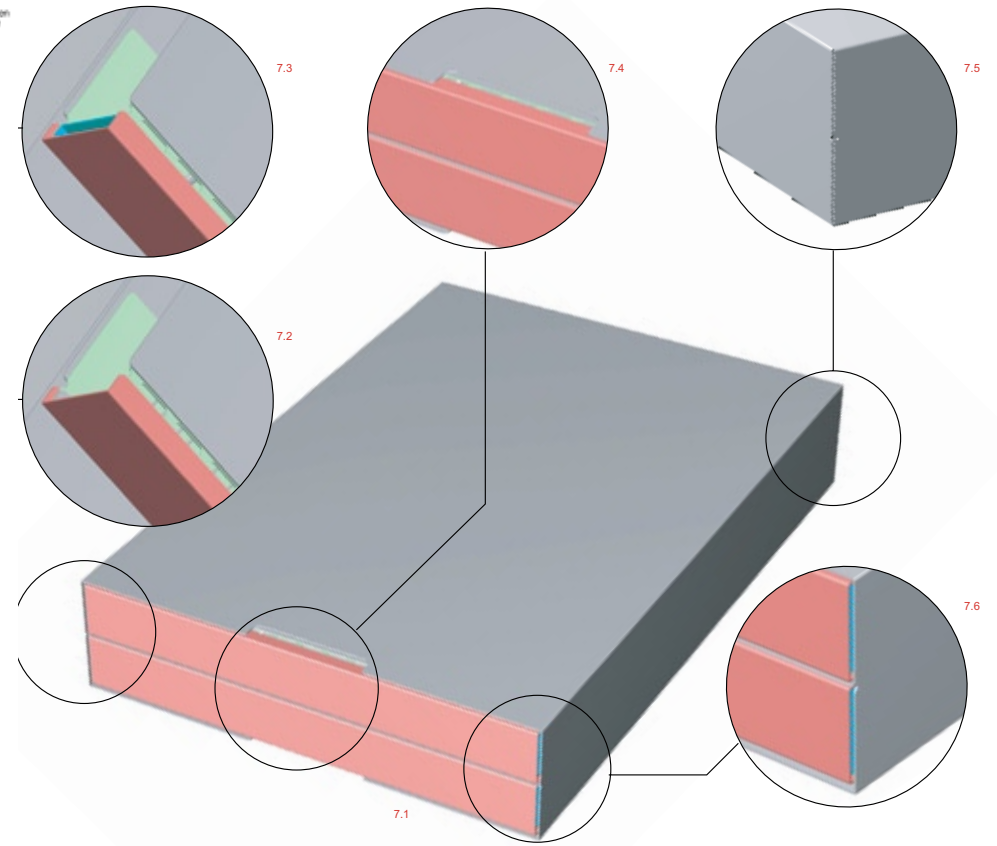
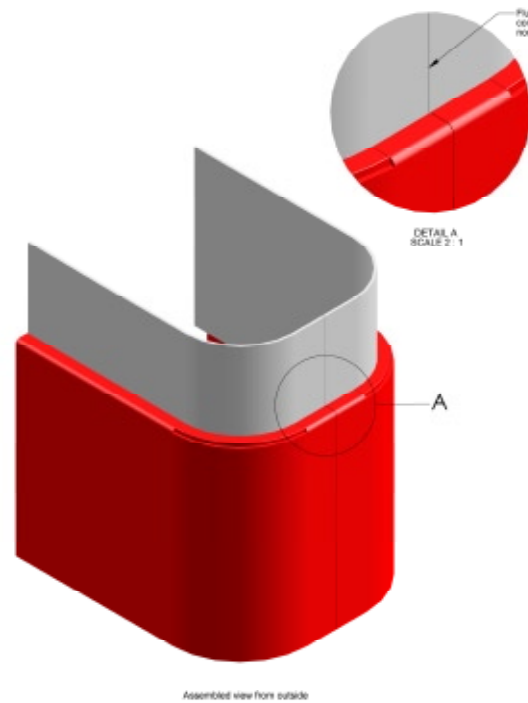
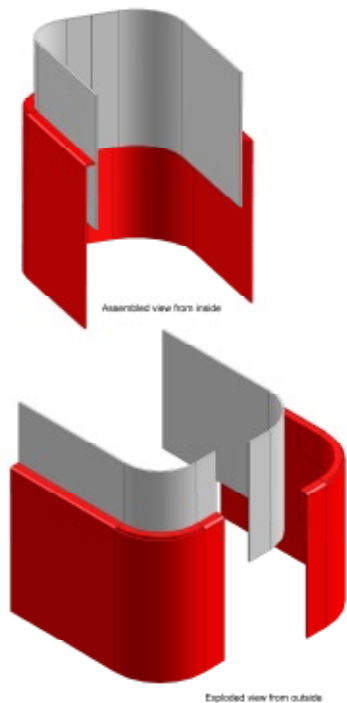

3D model, no render

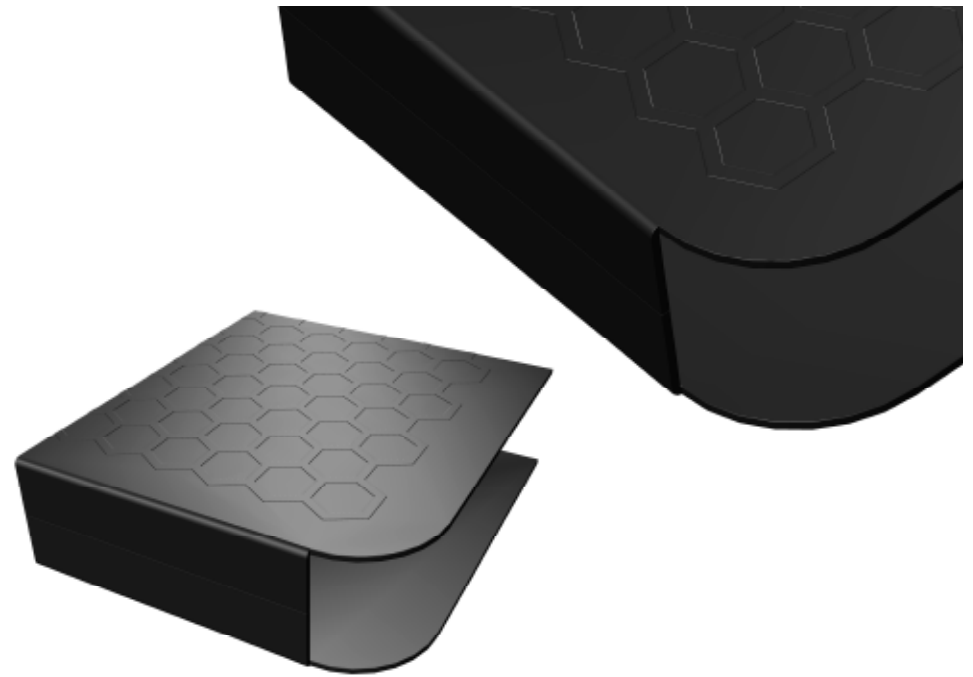
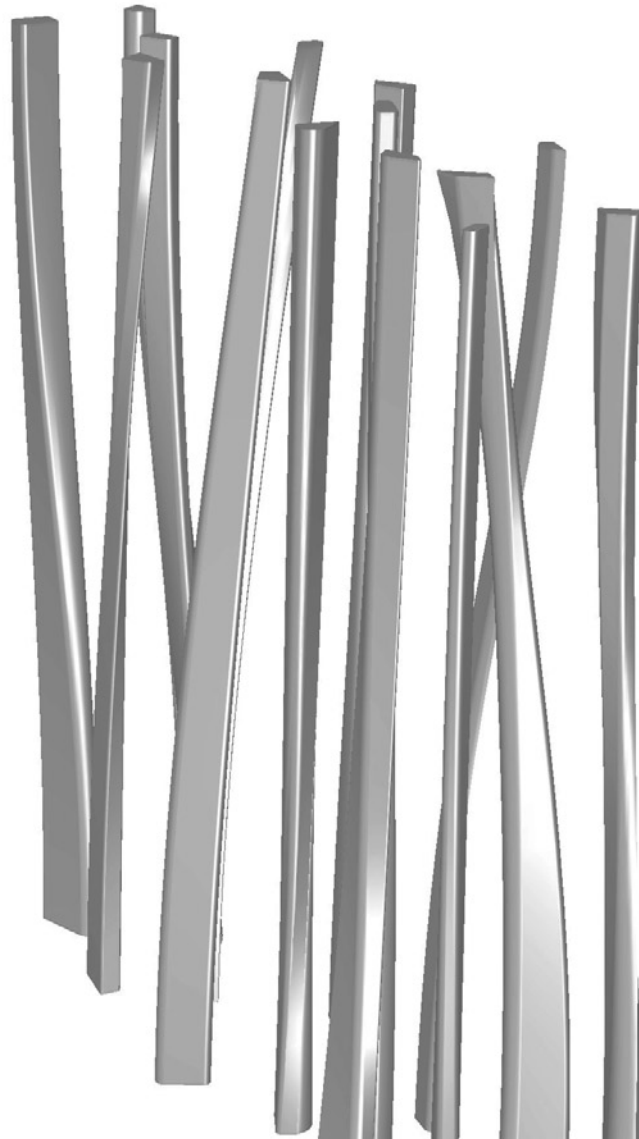
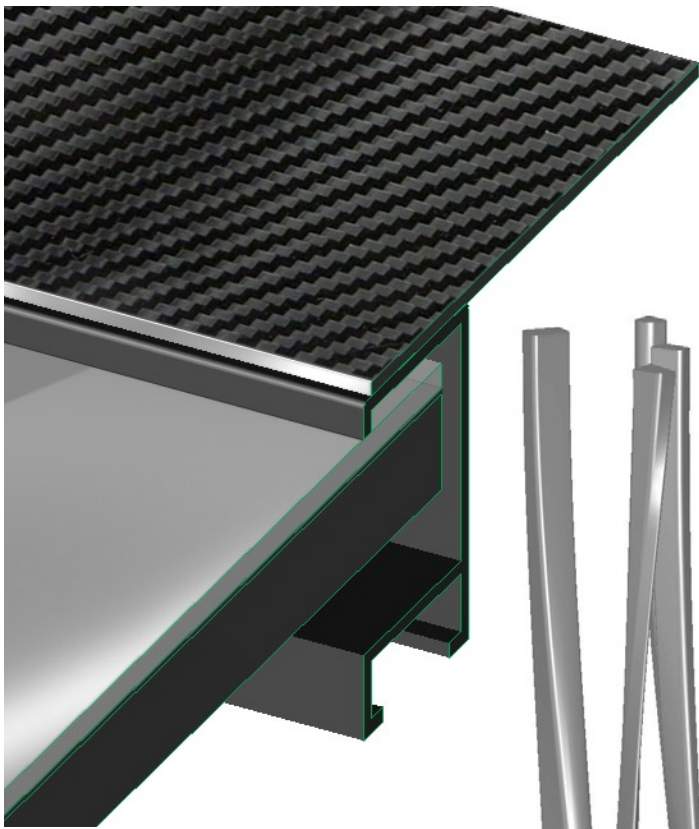

3D model & surface render



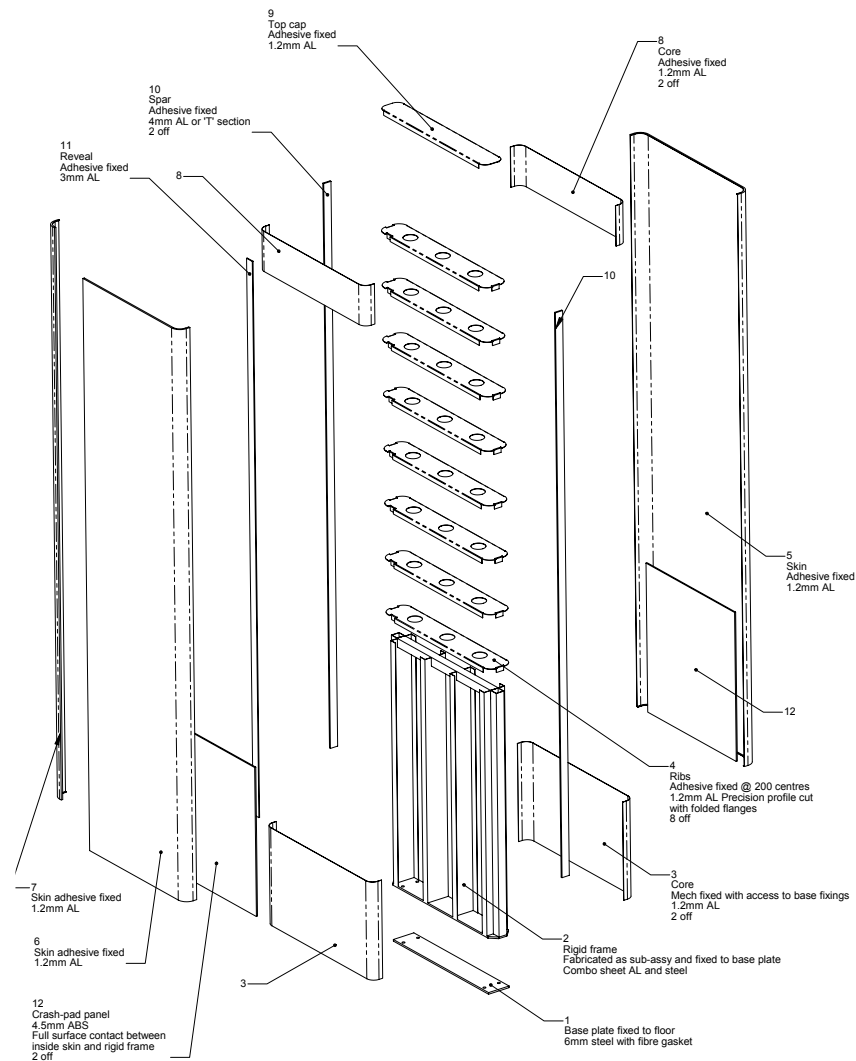
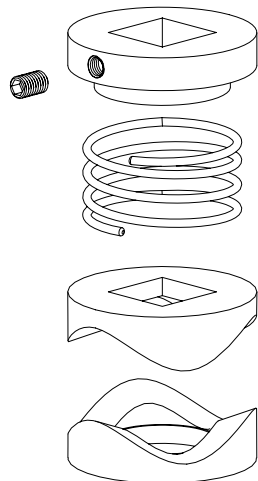
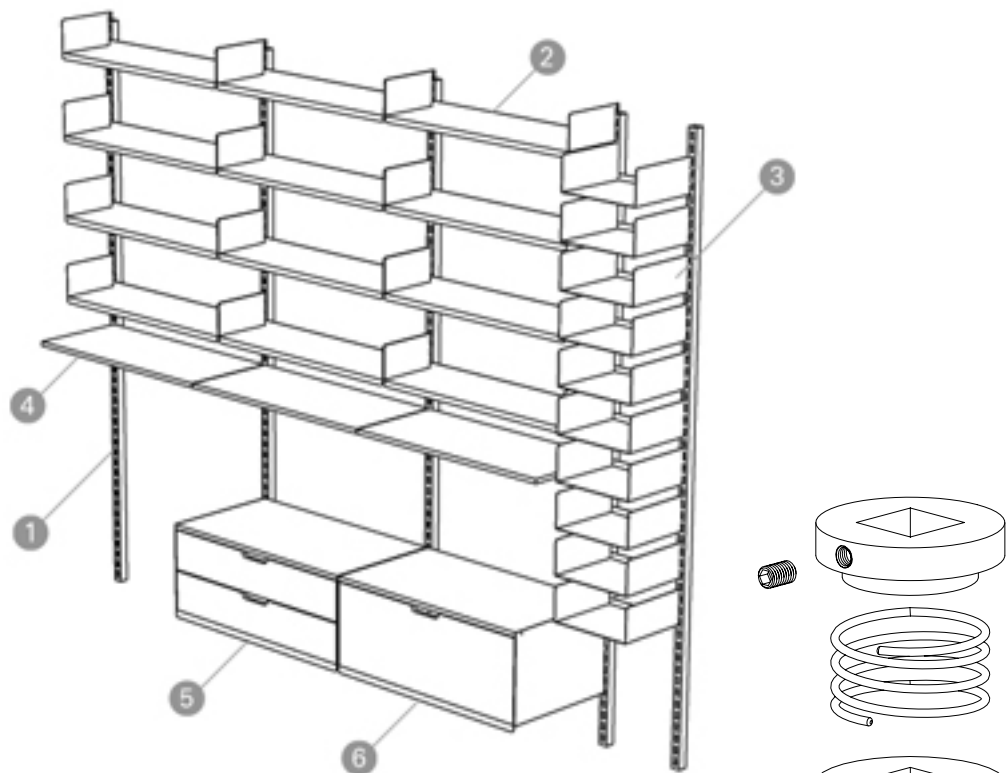

This drawing

This drawing shows design intent for exterior surfaces only. It serves as an aid to assist development of contractor's shop drawings. It is not intended to be relied upon as a construction specification. It does not supersede information shown in contractor's shop drawings or alter such requirements.

FROST Design 25/9/10

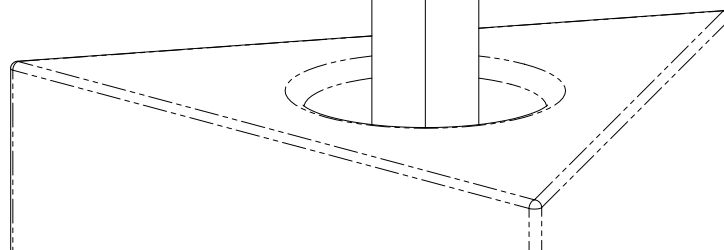

3D model, no render



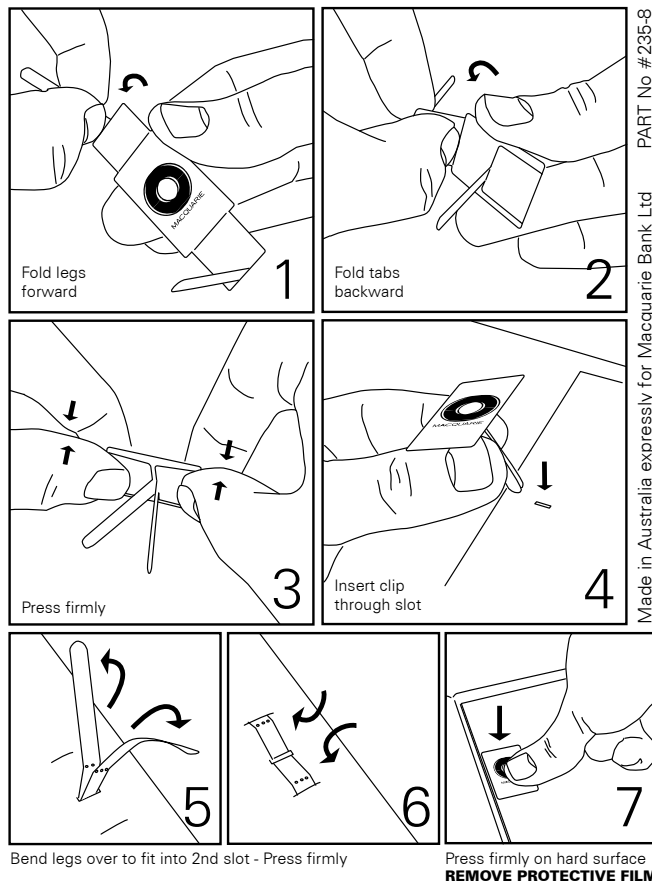

PART No #235-8  
Made in Australia expressly for Macquarie Bank Ltd

### 1. OPENING AND CLOSING THE CABINET

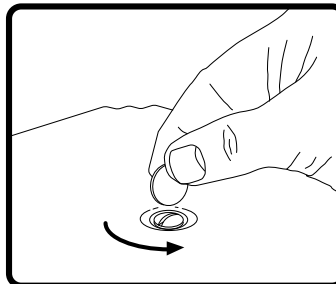

Undo top cover screw using a 5¢ piece, key head or screw driver. Only 1/4 turn is needed.

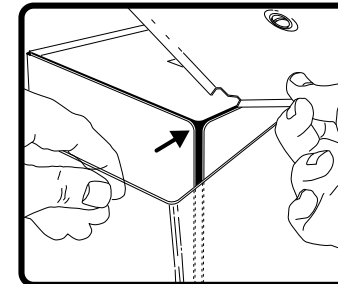

Remove top cover and perspex sides.  
(Note: perspex corner to be aligned with black corner of unit when re-fitting.)

### 2. GIFT CARD HOLDER

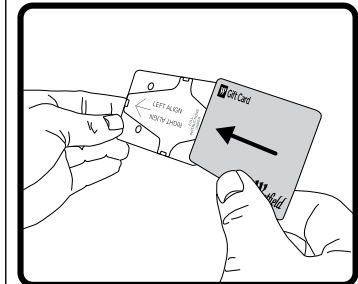

Decide which display option to use - right align or left align. This will depend upon the placement of the voice with the matching greeting card. Slide gift card into holder.

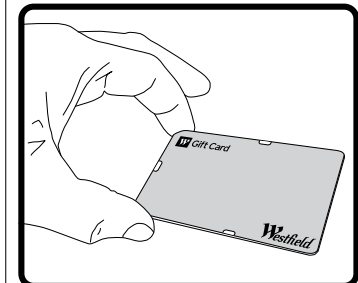

This shows the gift card in the holder aligned to the left. (Note: 3 spare gift card holders are stored under top cover. For use when more gift cards are displayed instead of message cards. Store under cover when not required.)

### MESSAGE CARD

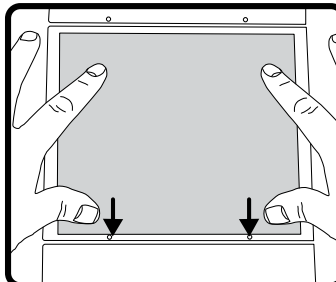

Centre message card on display panel. Align to bottom markers. There is no need to secure message card with a gift card holder as magnetic strips on the back of the card will hold it in place.

## INSTRUCTIONS

LIFT BY BASE ONLY

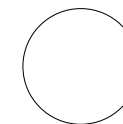

Designed and manufactured expressly for Westfield by compact desk®  
02 9327 1881  
Made in Australia  
Part No: 246

### 3. GREETING CARD

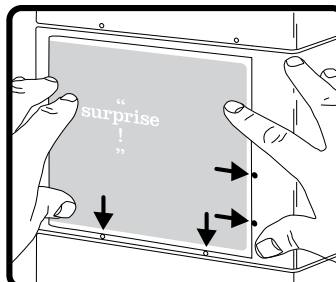

Place greeting card against panel. Align to bottom markers and holes, left or right.

### RIGHT ALIGN DISPLAY

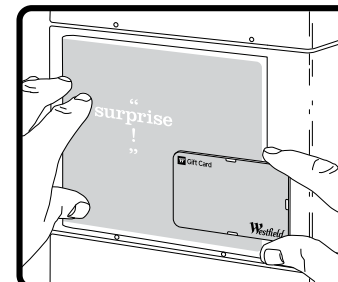

Apply gift card holder over greeting card so the 2 pins fit into the holes. A magnet in the holder grips the card and keeps it in place.

### LEFT ALIGN DISPLAY

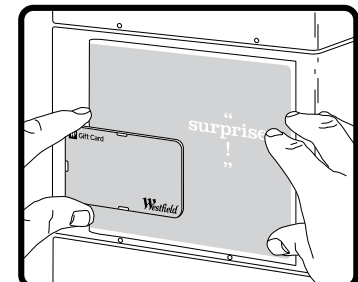

If you chose to 'left align', repeat the same steps as previous.

2D freehand illustration

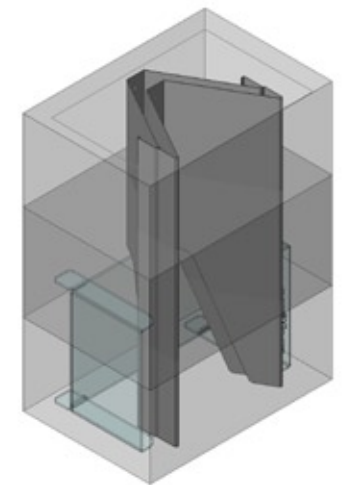
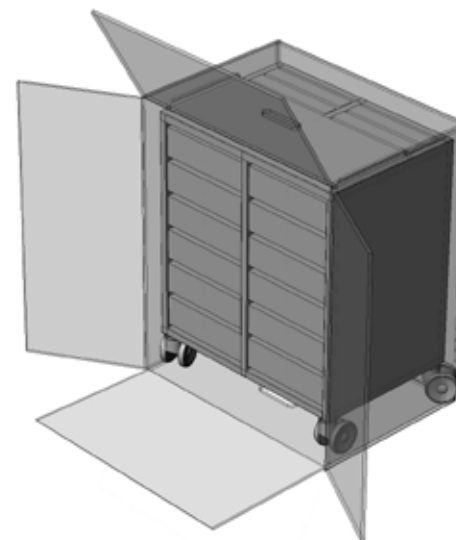
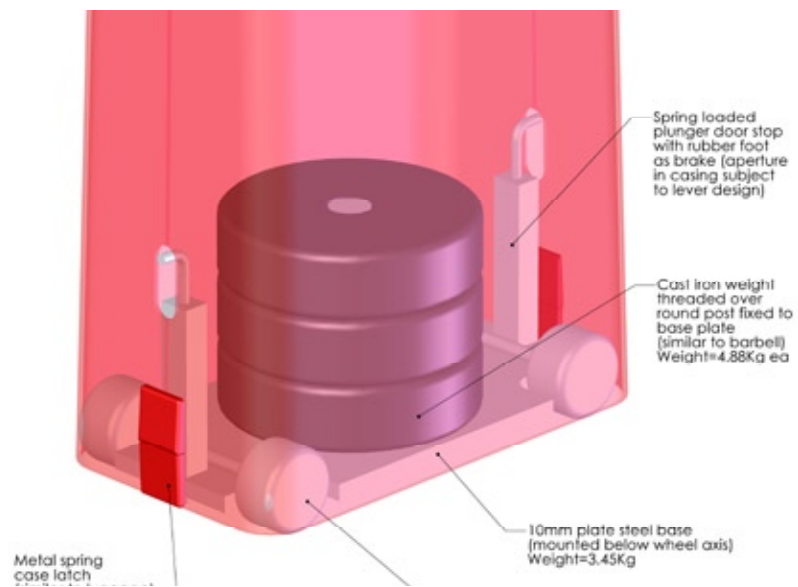
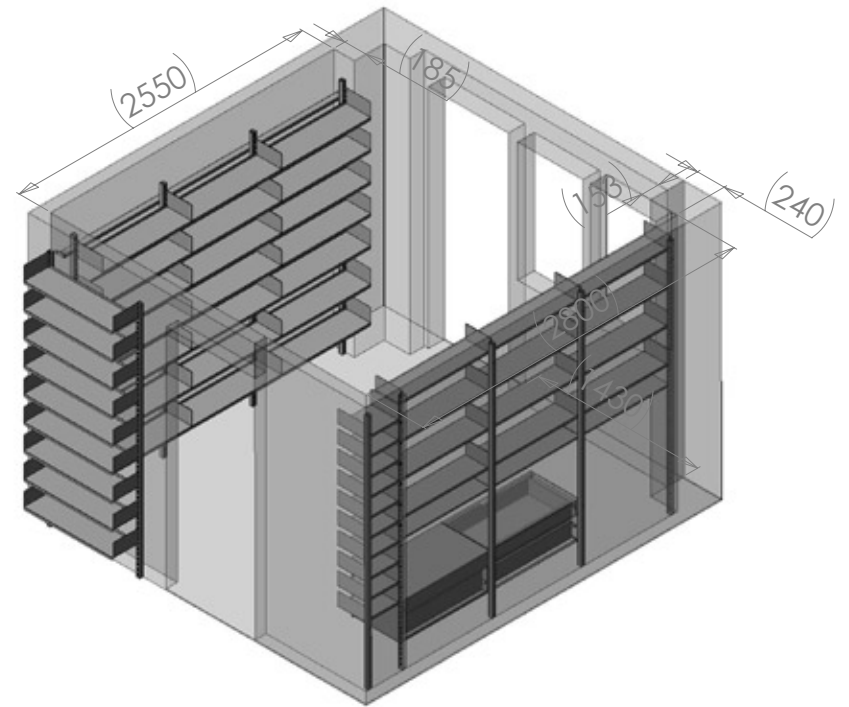
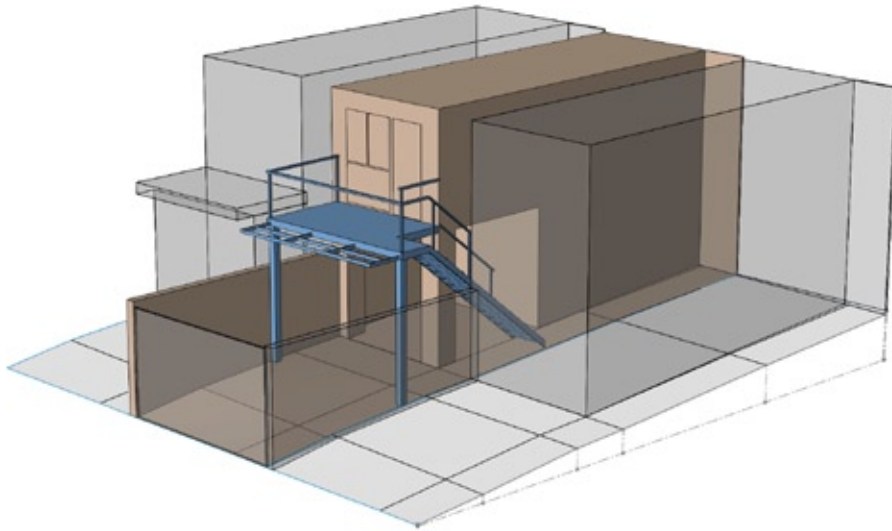

3D model, transparency render



Black flock interior

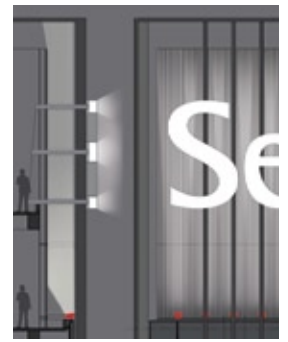
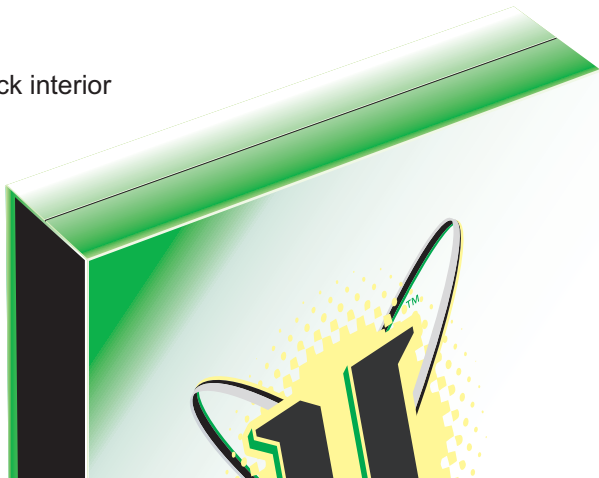

Sky Sign Illumination State #A : Front on only



2D Illustrator & Photoshop render